

4th Floor, Cardiac Cath Lab (West)

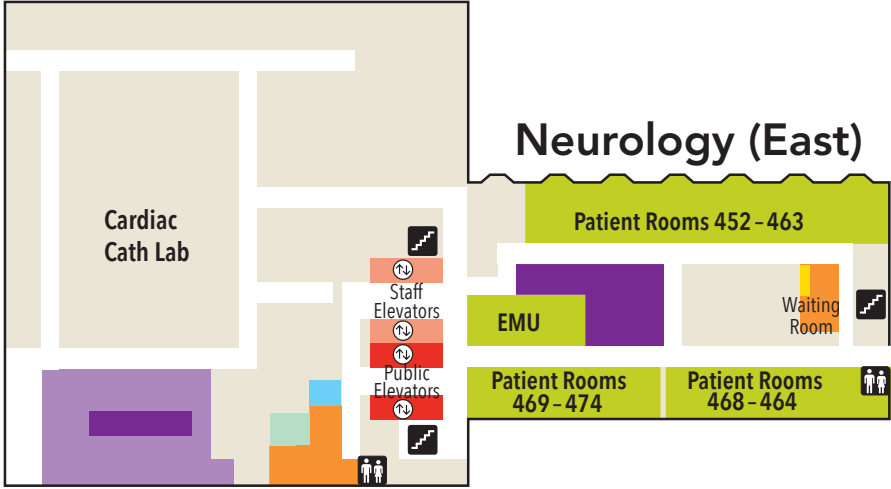

Neurology (East)

- Nurse station
- Patient rooms
- Outpatient Clinic
- Check-in / Check-out
- Pharmacy
- X-ray / Radiology
- Waiting Area
- Vending machines
- ↻ Public Elevators
- ↻ Staff Elevators
- Family Area

5th Floor, Day Hospital (West)

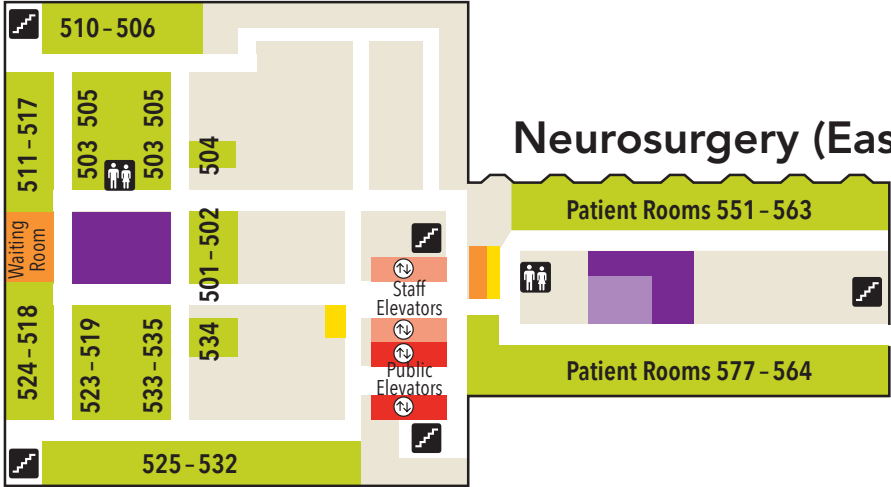

Neurosurgery (East)

- Stairs
- ♂ ♀ Restroom
- ☔ Shower
- i Information

6th Floor, Brenner Children's Hospital

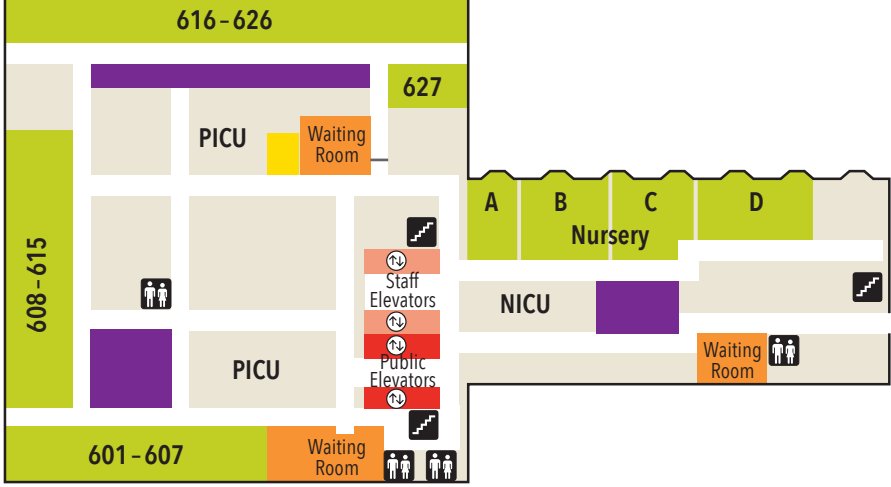

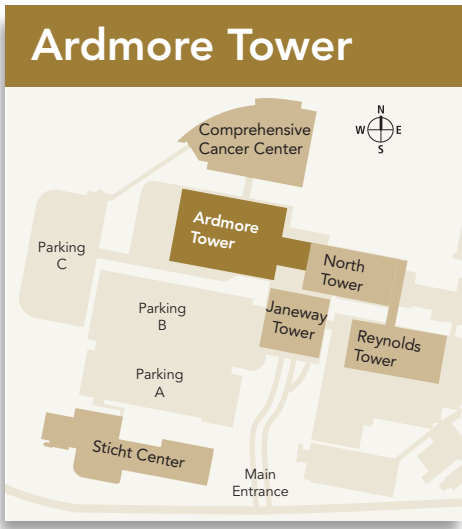

7th Floor, Brenner Outpatient Pediatric Services

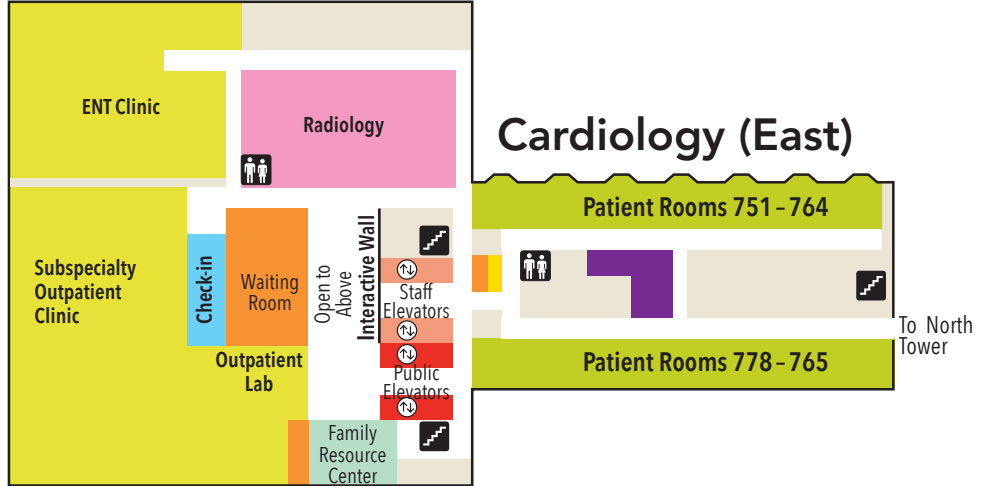

- Nurse station
- Patient rooms
- Outpatient Clinic
- Check-in / Check-out
- Pharmacy
- X-ray / Radiology
- Waiting Area
- Vending machines
- Public Elevators
- Staff Elevators
- Family Area

- Stairs
- Restroom
- Shower
- Information

8th Floor, General Pediatrics (West)

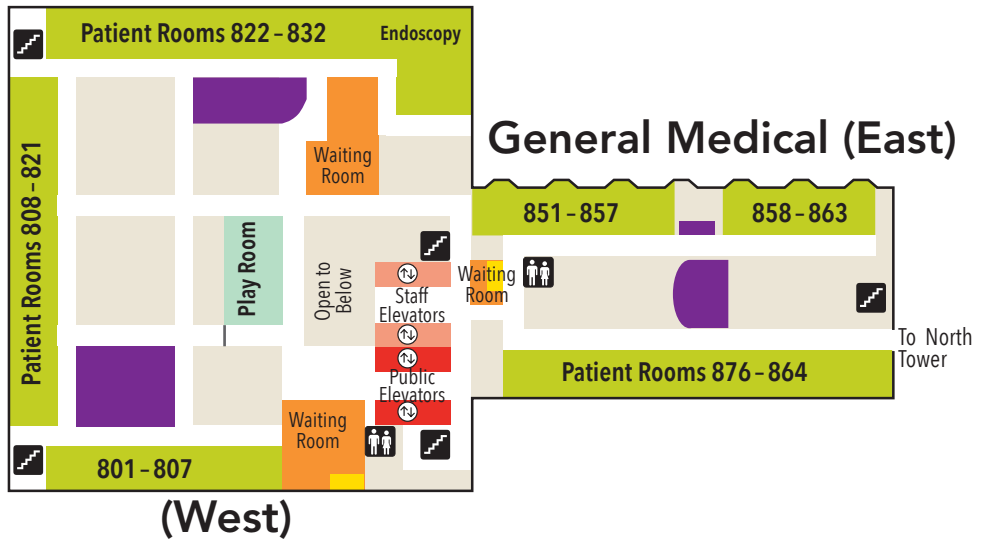

9th Floor, Pediatric Hematology / Oncology

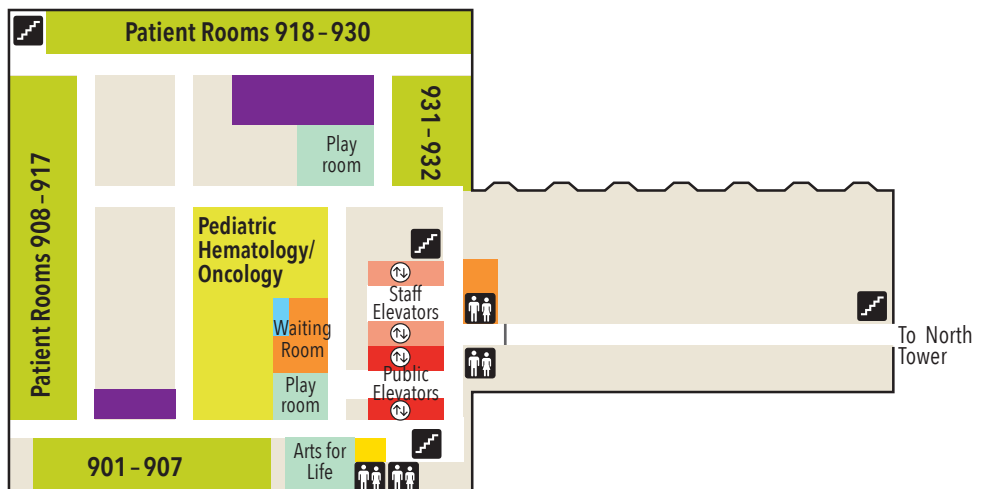

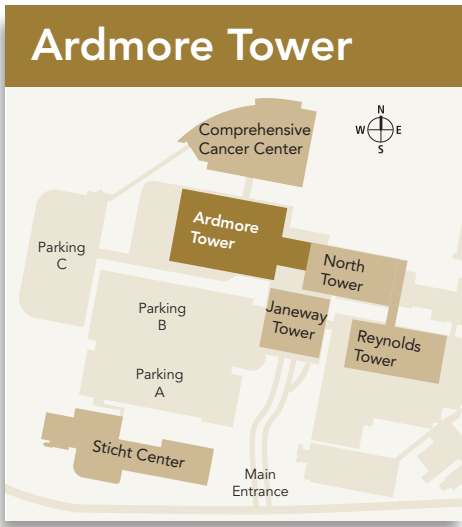

10th Floor, Pediatric Behavioral Health (West)

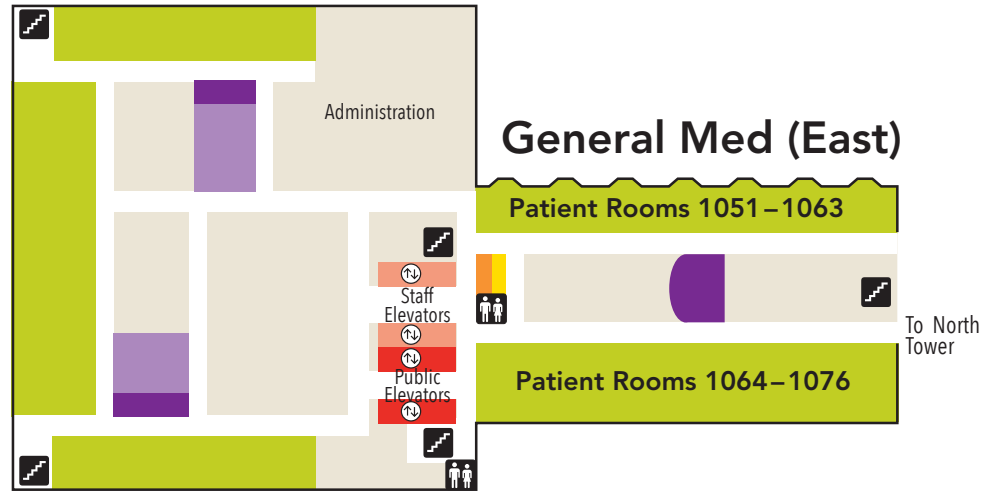

- Nurse station
- Patient rooms
- Outpatient Clinic
- Check-in / Check-out
- Pharmacy
- X-ray / Radiology
- Waiting Area
- Vending machines
- ↻ Public Elevators
- ↻ Staff Elevators
- Family Area
- Stairs
- Restroom
- Shower
- i Information

11th Floor, ENT / Transplant Surgery (West)

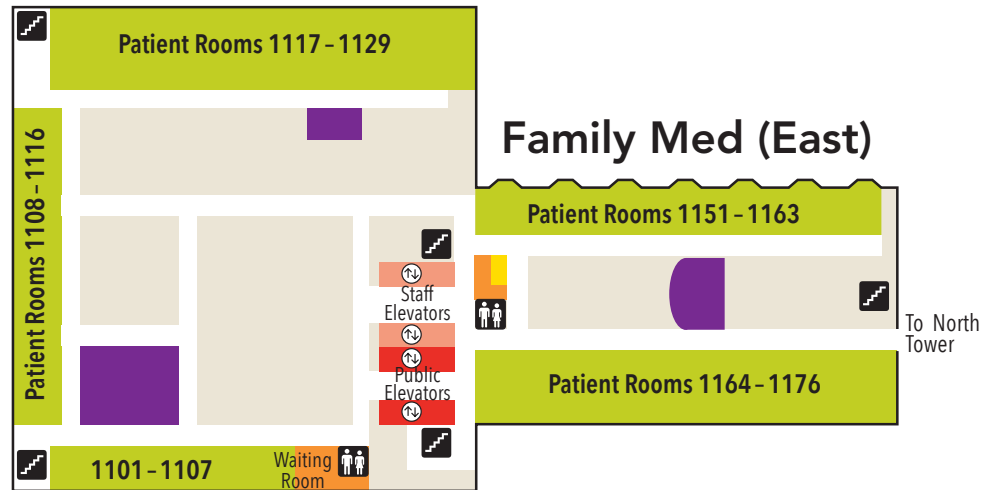

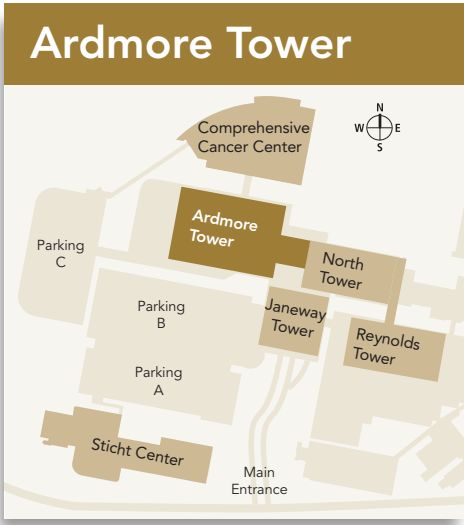

1SB Adult Emergency

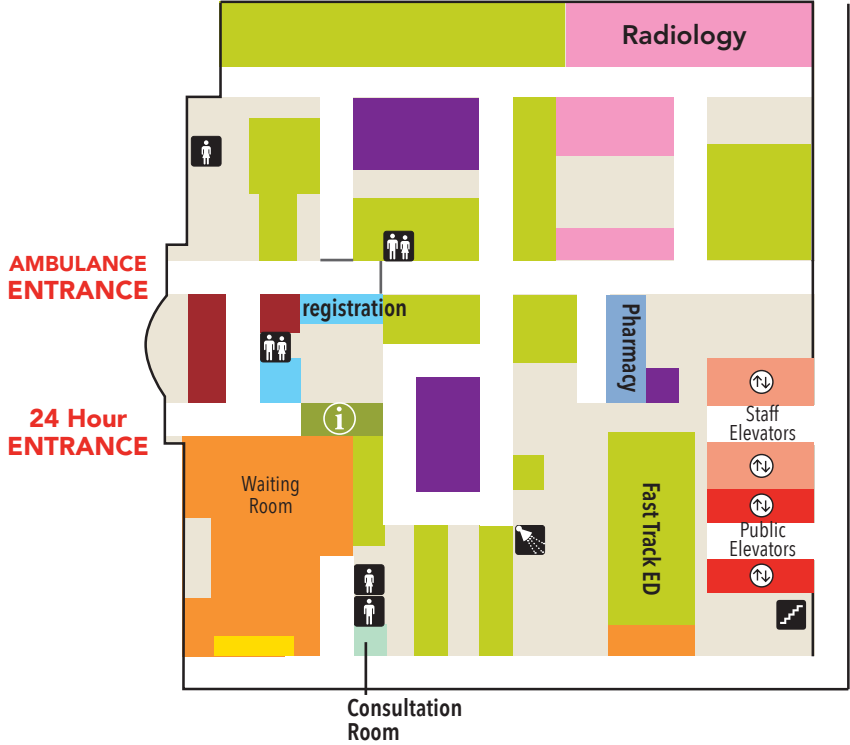

- Nurse station
- Patient rooms
- Outpatient Clinic
- Check-in / Check-out
- Pharmacy
- X-ray / Radiology
- Waiting Area
- Vending machines
- ↕ Public Elevators
- ↕ Staff Elevators
- Family Area
- Stairs
- Restroom
- Shower
- i Information

2SB Pediatric Emergency

