

4th Floor

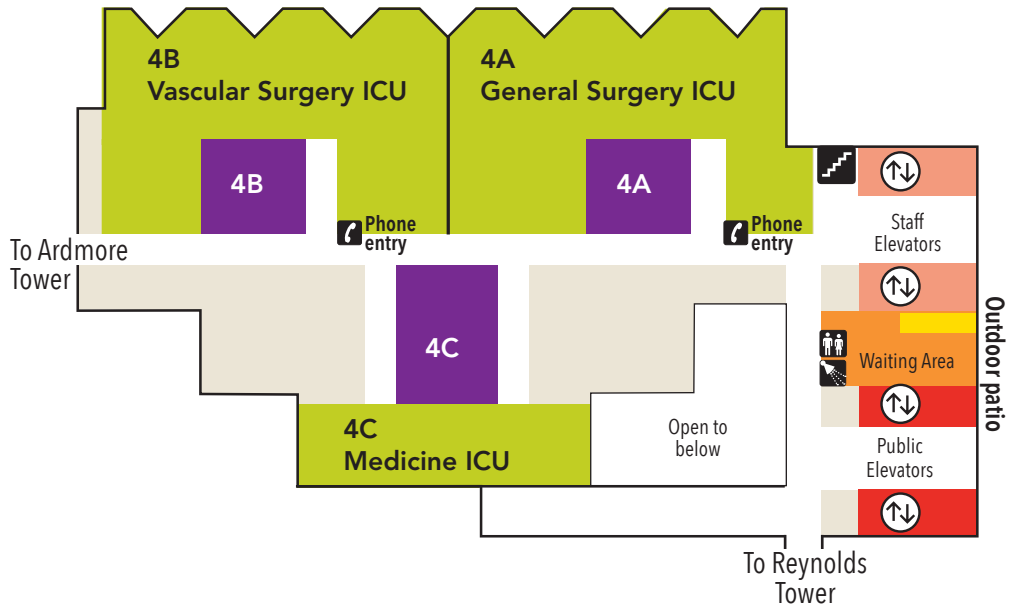

5th Floor

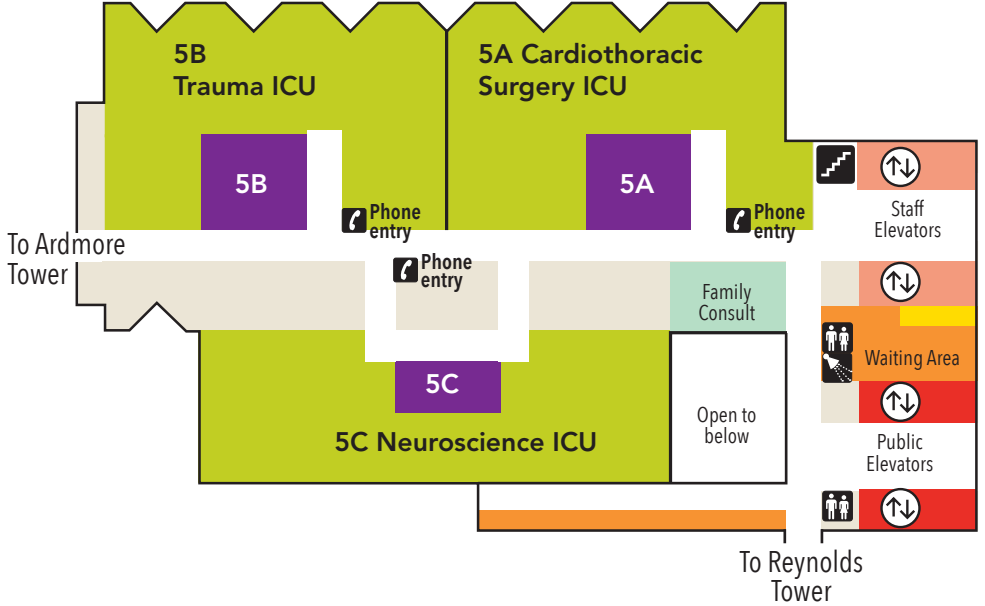

6th Floor

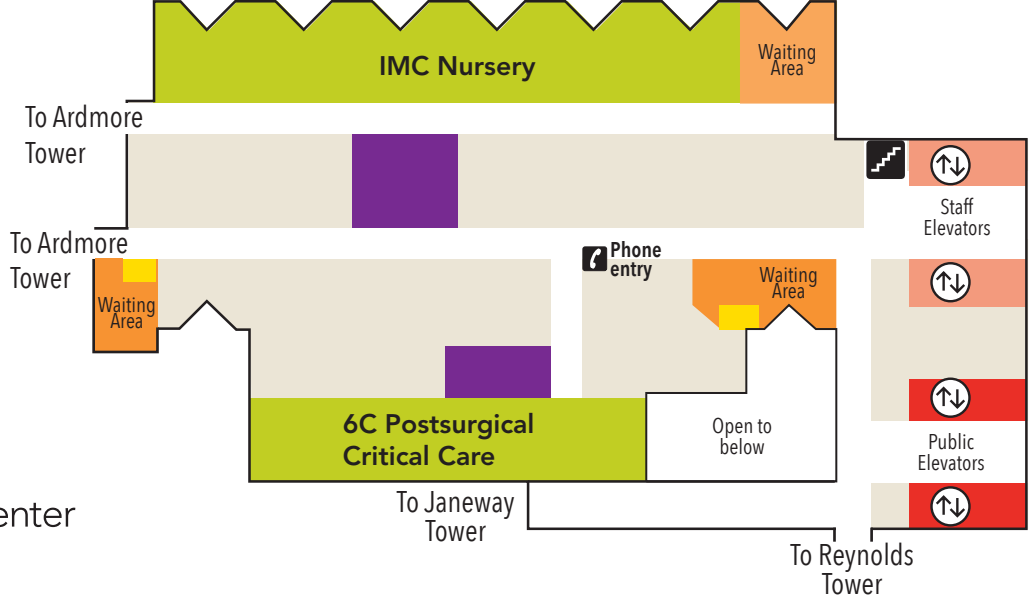

- Nurse station
- Patient rooms
- Outpatient Clinic
- Check-in / Check-out
- Pharmacy
- X-ray / Radiology
- Waiting Area
- Vending machines
- Public Elevators
- Staff Elevators
- Family Area
- Stairs
- Restroom
- Shower
- Information

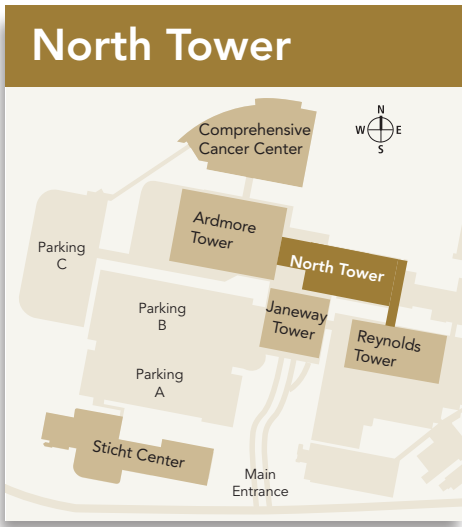

7th Floor – Coronary Care Unit

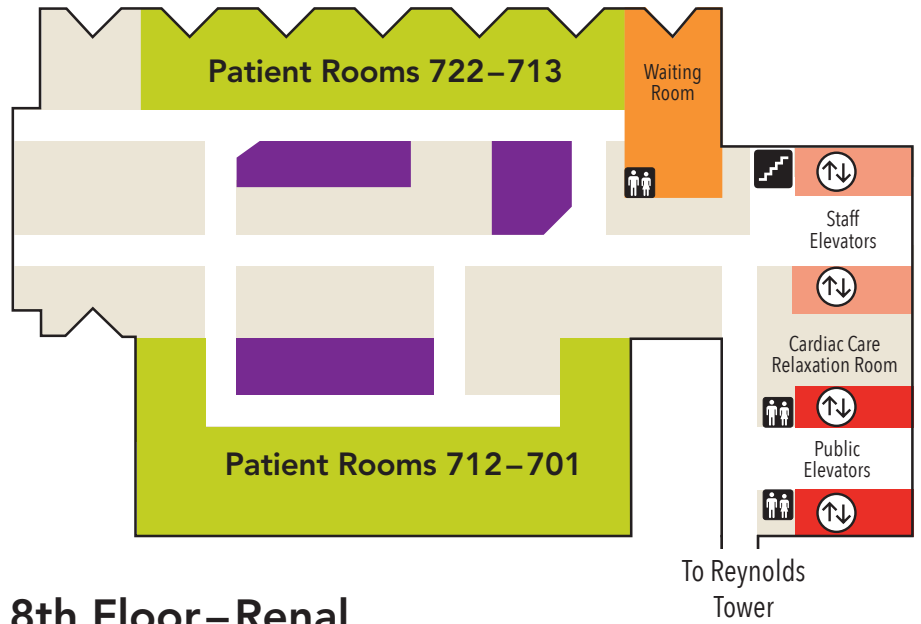

8th Floor – Renal

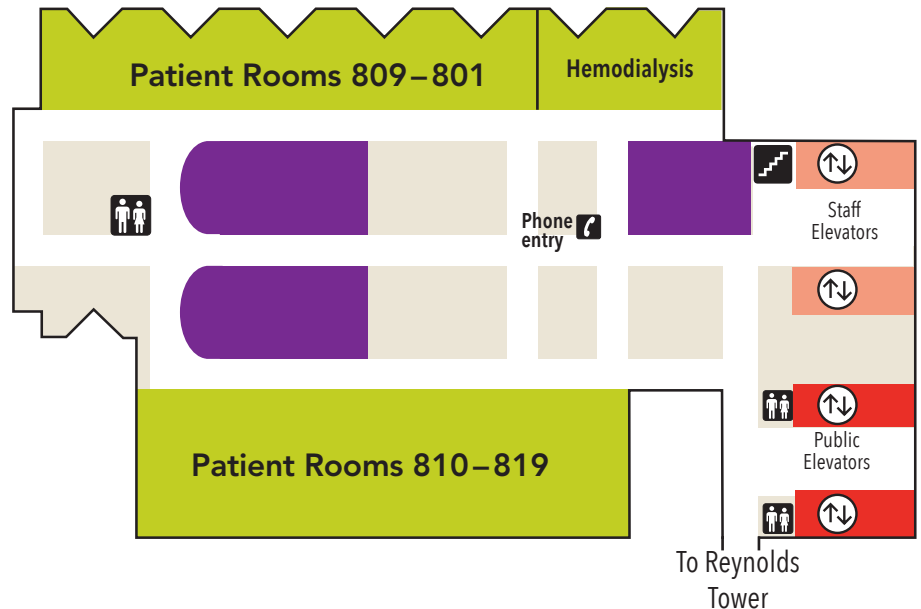

10th Floor – Plastic and Burn Surgery

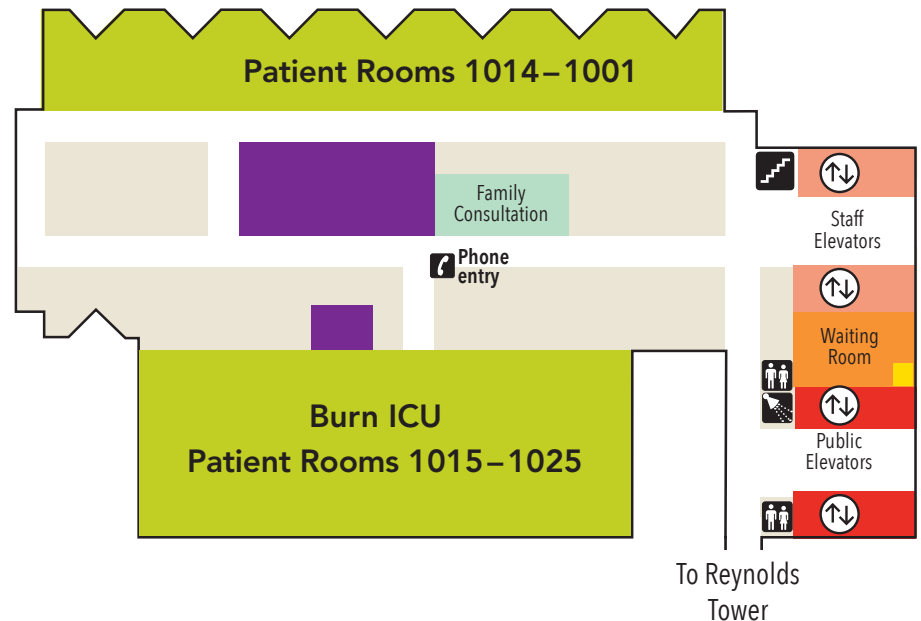

- Nurse station
- Patient rooms
- Outpatient Clinic
- Check-in / Check-out
- Pharmacy
- X-ray / Radiology
- Waiting Area
- Vending machines
- Public Elevators
- Staff Elevators
- Family Area
- Stairs
- Restroom
- Shower
- Information