

4th Floor, Medicine ICU

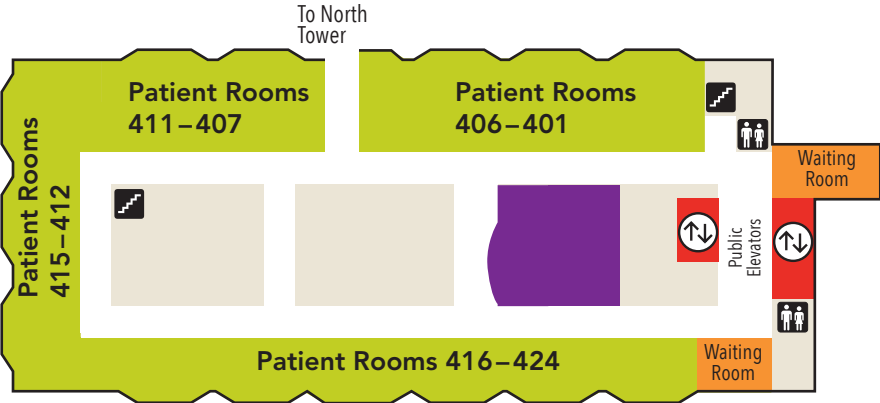

- Nurse station
- Patient rooms
- Outpatient Clinic
- Check-in / Check-out
- Pharmacy
- X-ray / Radiology
- Waiting Area
- Vending machines
- Public Elevators
- Staff Elevators
- Family Area
- Stairs
- Restroom
- Shower
- Information

5th Floor, Cardiotheracic Stepdown / Vascular

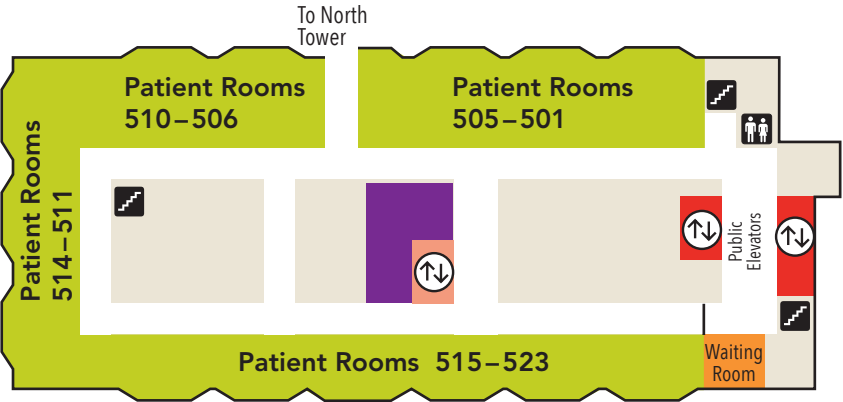

6th Floor, Intermediate Care

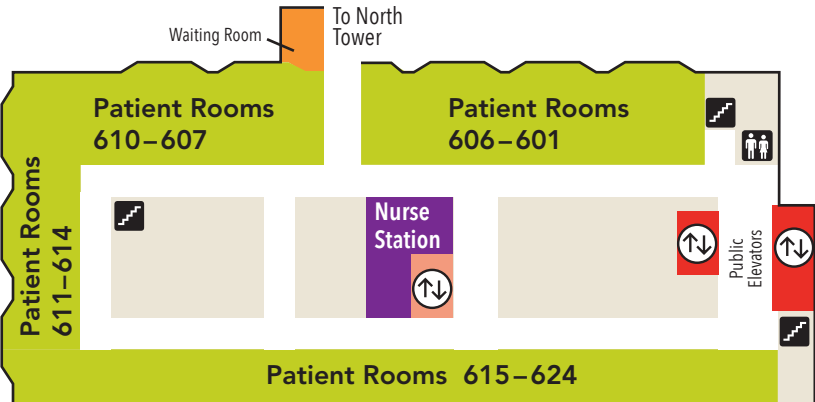

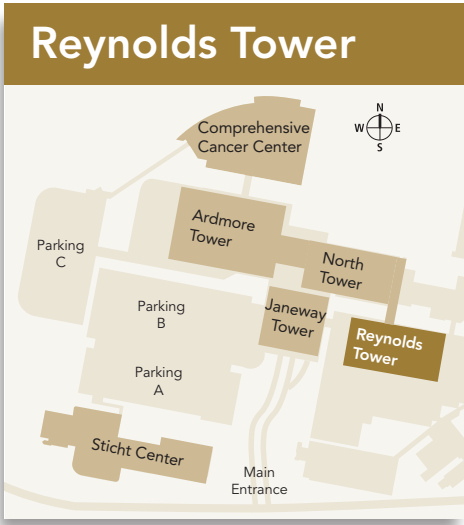

7th Floor, Cardiology

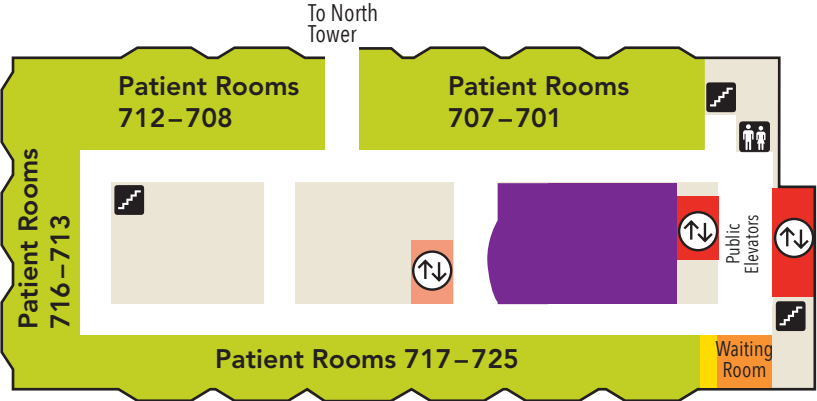

- Nurse station
- Patient rooms
- Outpatient Clinic
- Check-in / Check-out
- Pharmacy
- X-ray / Radiology
- Waiting Area
- Vending machines
- ↕ Public Elevators
- ↕ Staff Elevators
- Family Area
- ↗ Stairs
- ♂ ♀ Restroom
- ☔ Shower
- i Information

8th Floor, Medical Surgery

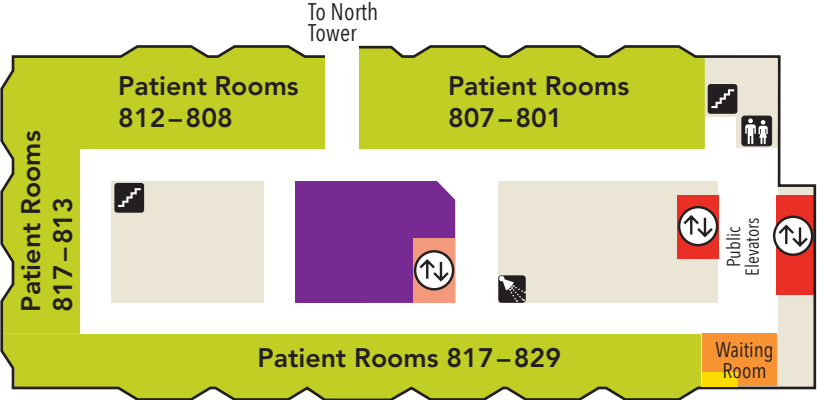

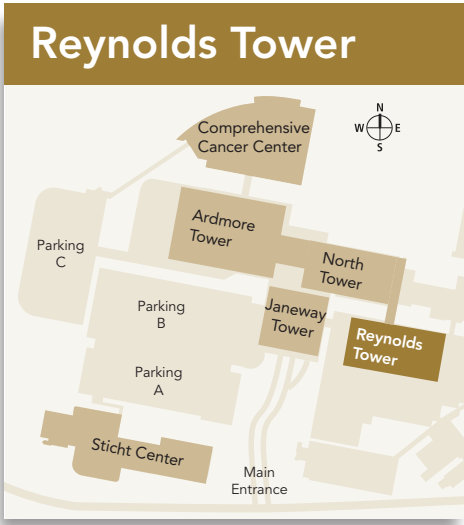

10th Floor, Women's Health

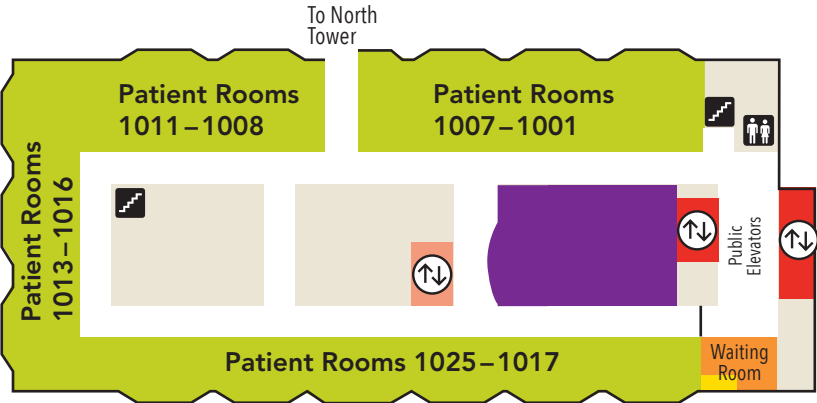

- Nurse station
- Patient rooms
- Outpatient Clinic
- Check-in / Check-out
- Pharmacy
- X-ray / Radiology
- Waiting Area
- Vending machines
- Public Elevators
- Staff Elevators
- Family Area
- Stairs
- Restroom
- Shower
- Information

11th Floor, Trauma Surgery

